

# HE3RWBA

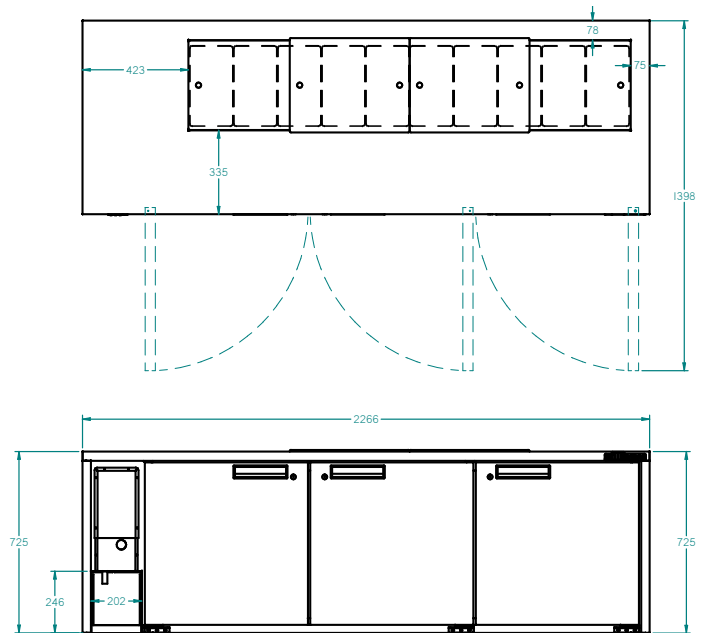

CATEGORY	FOODSERVICE UPRIGHTS
RANGE	<b>Emerald</b>
UNIT	REFRIGERATOR
TYPE	REMOTE
DOORS	3

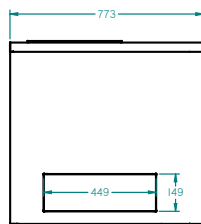

## SPECIFICATIONS

CAPACITY LITRES	900
TEMPERATURE	1°C / 4°C
DIMENSIONS - W X D X H (ON 150 MM H LEGS)	2266 W x 773 D x 875 H
WEIGHT UNPACKED (KG)	200

## STANDARD INCLUSIONS \*\*\*

DOOR TYPE	Standard: SD (Solid Door)    Optional: DR (Drawer), PT (Pass Thru)
FINISH (INTERIOR AND EXTERIOR EXCLUDING REAR AND UNDER)	SS (Stainless Steel)
SHELVES/DOOR	1
BLOWN AIRWELL (100MM DEEP 1/3 PANS INCLUDED)	10 X 1/3 PANS

## ELECTRICAL

POWER SUPPLY	10 amp	
FRIDGE MODELS	RUNNING AMPS	0.6
FREEZER MODELS	RUNNING AMPS	2.3

## GAS TYPE

REFRIGERANT	FRIDGE MODELS	R404a
REFRIGERATION WATTAGES FOR REMOTE UNITS		
FRIDGE MODELS - SOLID DOOR BA		980 @ -10°C SST

\*\*\* For **OPTIONS** refer to the current Williams Price Guide